

M2M Air-Cooled Mig Welding Torch - Multijust

Ratings:	230A CO ₂ , 200A mixed gas M21, 110A pulse. EN60974-7 @ 60% duty cycle. 0.8mm-1.2mm wires
----------	---

The Arc M2M is ideal for 0.8-1.0mm hard wires and industrial environments. Fitted with a longer neck with 360° rotation, perfect for multiple positions in difficult to reach areas.



ARC M INDUSTRIAL MIG TORCH PACKAGES - MULTIJUST

M2M Multijust Torches are supplied with a Euro termination as standard and are supplied 'ready to weld' with all wear parts fitted.

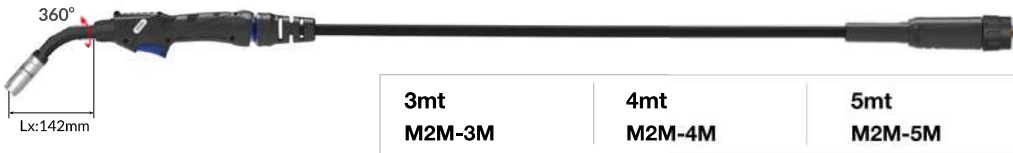

Wear Parts

A Nozzles

Part Number	Description	Bore	Wall	Material
•AM2CN	Conical Nozzle Assembly	15mm	1.9mm	Copper
AM2TN	Tapered Nozzle Assembly	12mm	1.9mm	Copper

B Contact Tips

Part Number	Description	Size (mm)	Wire Size (mm-inch)	Material
AM2CT08	Contact Tip	M8*29.5	0.8 - 0.030	Copper
AM2CT09	Contact Tip	M8*29.5	0.9 - 0.035	Copper
•AM2CT10	Contact Tip	M8*29.5	1.0 - 0.040	Copper
AM2CT12	Contact Tip	M8*29.5	1.2 - 0.045	Copper
AM2CT08A	Contact Tip	M8*29.5	0.8 - 0.030	Copper
AM2CT10A	Contact Tip	M8*29.5	1.0 - 0.040	Copper
AM2CT12A	Contact Tip	M8*29.5	1.2 - 0.045	Copper

C Tip Adaptors

Part Number	Description	Material
•AM2TA	Tip Adaptor	Brass

• Denotes torch package standard wear part set-up

D Liners

Part Number	Description	Wire Size
•AM2524-30	Steel Liner x 3mt	1.0-1.2mm
•AM2524-40	Steel Liner x 4mt	1.0-1.2mm
•AM2524-50	Steel Liner x 5mt	1.0-1.2mm

For alternate liner options please refer to page 38

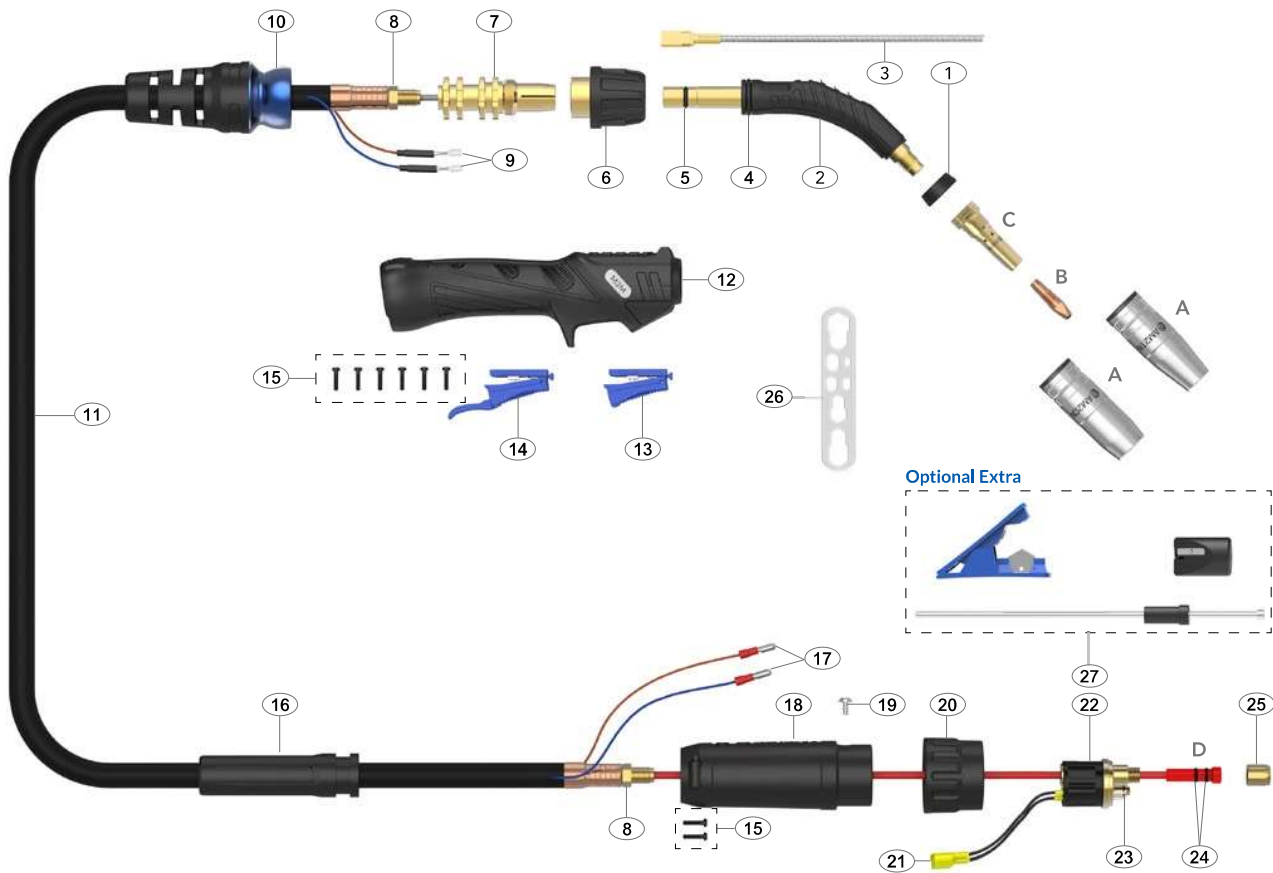

Spare Parts

Part Number	Description
1 AM2AP	Neck Insulator
2 AM2001M	Swan Neck Assembly - Multijust
3 AM2MJL	Neck Jump Liner 0.8-1.2mm - Hard Wire
4 AM-MJ1509	Neck 'O' Ring (Ø14xØ2.5)
5 AM-MJ1508	Neck 'O' Ring (Ø8.5xØ1.5)
6 AM1516M	Neck Nut - Multijust
7 AM1515M	Socket Connection
8 AM1505	Lock Nut
9 AM1521	Cable Terminal
10 AM1514	Handle Cable Support c/w Ball Joint
11 AM2503-30	Ultraflex Cable Assembly x 3mt
AM2503-40	Ultraflex Cable Assembly x 4mt
AM2503-50	Ultraflex Cable Assembly x 5mt
12 AM2514	Handle Kit
13 AM2516	Microswitch Standard Trigger
14 AM2516L	Microswitch Extended Trigger
15 AMSP1-1	Screw Pack
16 AM2841	Cable Support
17 AM1522	Cable Terminal Male
18 AM2578/S	Gun Plug Housing
19 AML1541	Gun Plug Screw
20 AMC1519/S	Gun Plug Nut
21 AM1523	Gun Plug Terminal Female

Part Number	Description
22 AM1528	Hybrid Gun Plug Body c/w Spring Pins
23 AM1524	Gun Plug 'O' Ring
24 AMLOR	Liner 'O' Ring
25 AM1826	Liner Retaining Nut
26 AMWS	Wear Parts Spanner
Optional Extra	
27 AMCLST-KITS	Combi-Liner Set-up kit

Welding with Soft Wires

For welding with Aluminum wires use a Combi-liner (page 38). Optimum installation is achieved when using the Combi-liner set-up kit.